

**Exhibitors Loading Dock**

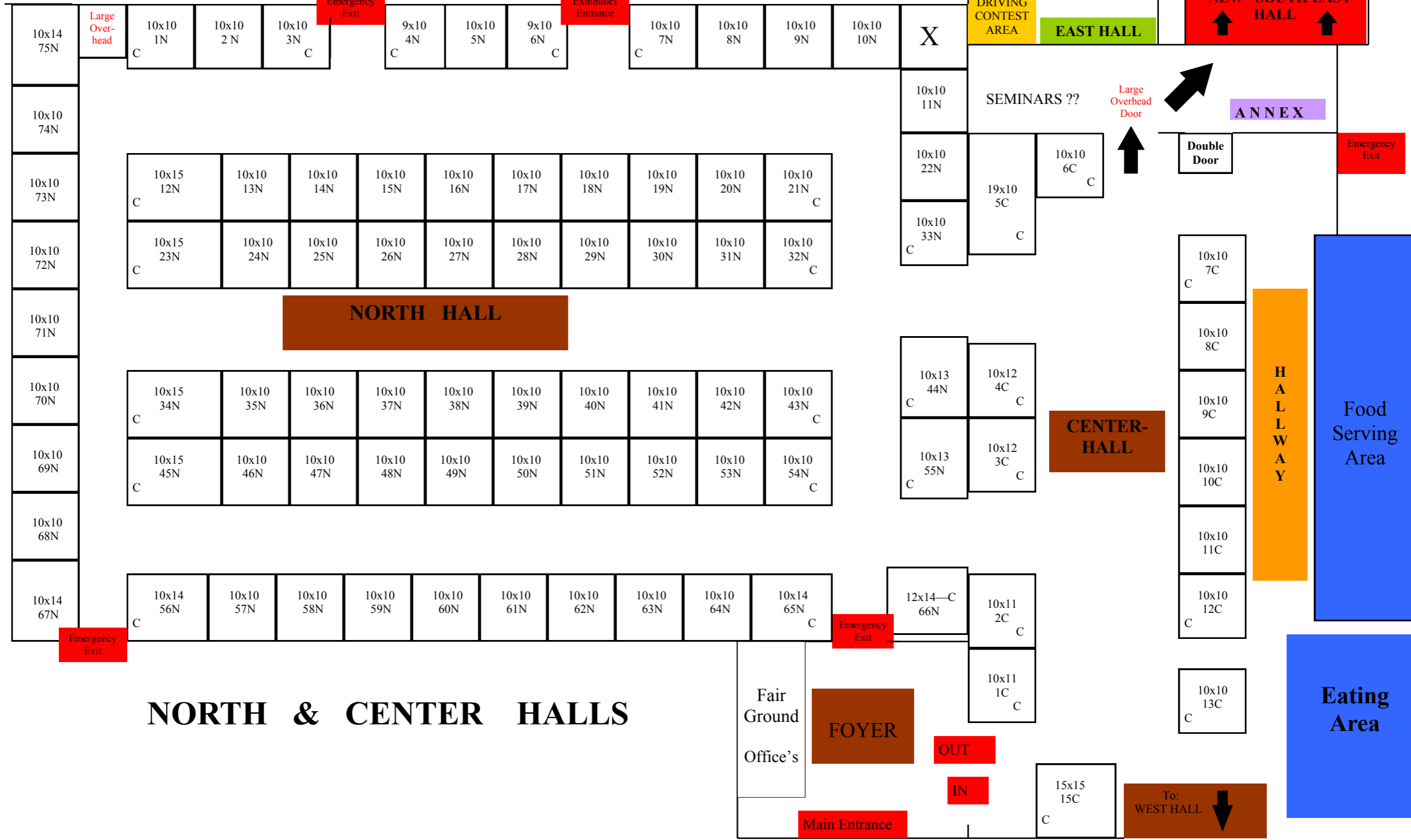

**NORTH & CENTER HALLS**

**NORTH HALL**

**CENTER-HALL**

**HALLWAY**

**"NEW" SOUTH EAST HALL**

**EAST HALL**

**NAIL DRIVING CONTEST AREA**

**SEMINARS ??**

**ANNEX**

**Double Door**

**Food Serving Area**

**Eating Area**

**FOYER**

**OUT**

**IN**

**Main Entrance**

**To: WEST HALL**

**Large Over-head**

**Large Overhead Door**

**Emergency Exit**

**Emergency Exit**

**Emergency Exit**

**Fair Ground Office's**

**15x15 15C**

**10x10 13C**

**10x10 12C**

**10x10 11C**

**10x10 10C**

**10x10 9C**

**10x10 8C**

**10x10 7C**

**10x10 33N**

**19x10 5C**

**10x10 6C**

**10x10 11N**

**X**

**10x10 10N**

**10x10 9N**

**10x10 8N**

**10x10 7N**

**9x10 6N**

**10x10 5N**

**9x10 4N**

**10x10 3N**

**10x10 2N**

**10x10 1N**

**10x14 75N**

**10x10 74N**

**10x10 73N**

**10x10 72N**

**10x10 71N**

**10x10 70N**

**10x10 69N**

**10x10 68N**

**10x14 67N**

**12x14-C 66N**

**10x11 2C**

**10x11 1C**

**10x15 12N**

**10x10 13N**

**10x10 14N**

**10x10 15N**

**10x10 16N**

**10x10 17N**

**10x10 18N**

**10x10 19N**

**10x10 20N**

**10x10 21N**

**10x15 23N**

**10x10 24N**

**10x10 25N**

**10x10 26N**

**10x10 27N**

**10x10 28N**

**10x10 29N**

**10x10 30N**

**10x10 31N**

**10x10 32N**

**10x15 34N**

**10x10 35N**

**10x10 36N**

**10x10 37N**

**10x10 38N**

**10x10 39N**

**10x10 40N**

**10x10 41N**

**10x10 42N**

**10x10 43N**

**10x15 45N**

**10x10 46N**

**10x10 47N**

**10x10 48N**

**10x10 49N**

**10x10 50N**

**10x10 51N**

**10x10 52N**

**10x10 53N**

**10x10 54N**

**10x14 56N**

**10x10 57N**

**10x10 58N**

**10x10 59N**

**10x10 60N**

**10x10 61N**

**10x10 62N**

**10x10 63N**

**10x10 64N**

**10x14 65N**

**10x14 56N**

**10x10 57N**

**10x10 58N**

**10x10 59N**

**10x10 60N**

**10x10 61N**

**10x10 62N**

**10x10 63N**

**10x10 64N**

**10x14 65N**

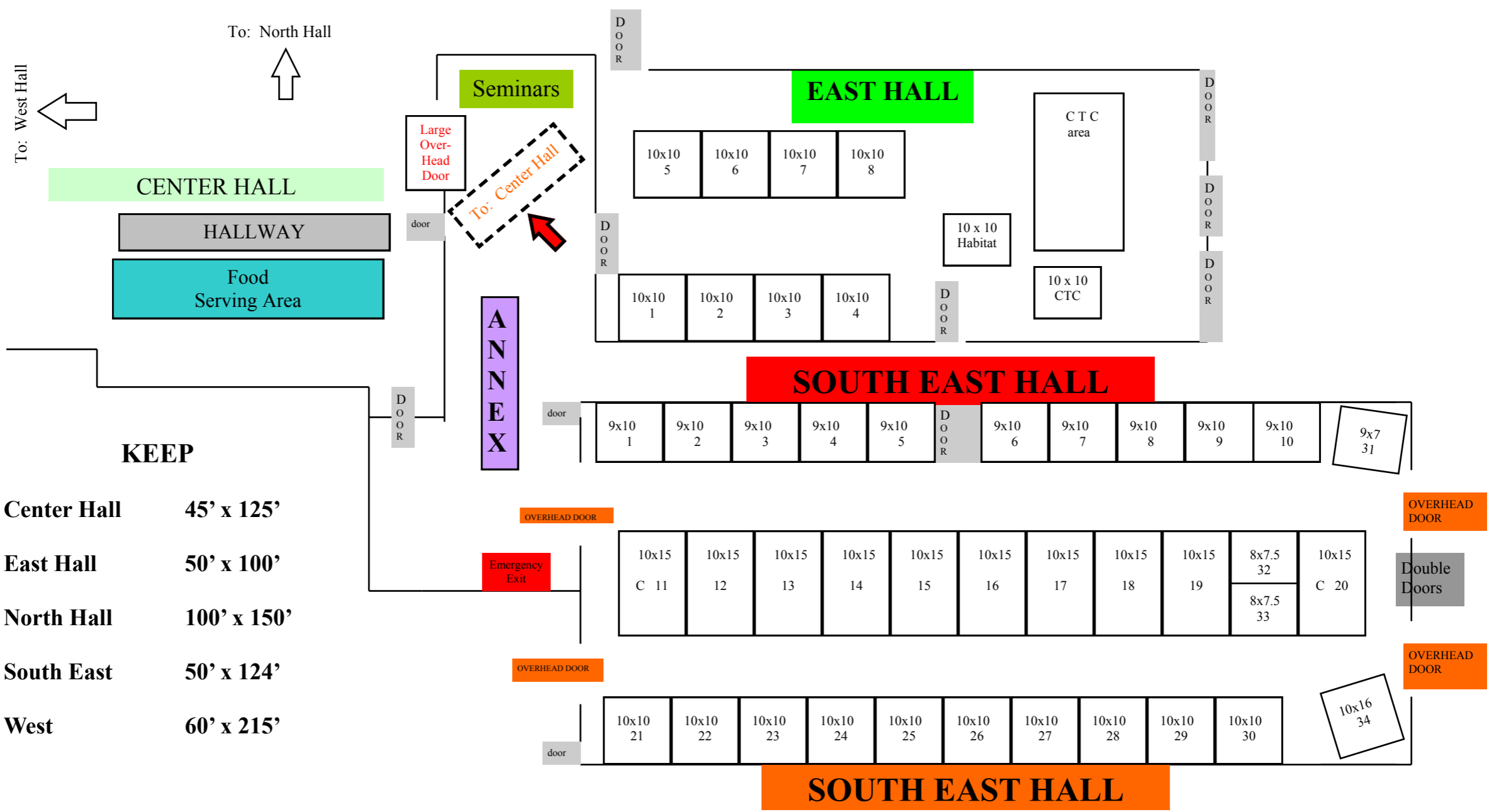

<b>Center Hall</b>	<b>45' x 125'</b>
<b>East Hall</b>	<b>50' x 100'</b>
<b>North Hall</b>	<b>100' x 150'</b>
<b>South East</b>	<b>50' x 124'</b>
<b>West</b>	<b>60' x 215'</b>

Ladies & Men Rest Rooms

CORRIDOR

Emergency Exit

Exhibitors Entrance

Emergency Exit

Emergency Exit

Electrical Rms	10x14 1W	10x10 2W	10x10 3W	10x10 4W	10x10 5W	10x10 6W	10x10 7W		10x10 8W	10x10 9W	10x10 10W	10x10 11W	10x10 12W	10x10 13W	10x10 14W	10x12 15W		10x10 16W	10x10 17W	10x10
	C						C		C							C		C		

WEST HALL

CENTER HALL

C	10x10 18W	10x10 19W	10x10 20W	10x10 21W	10x10 22W	10x10 23W	10x10 24W	10x10 25W	10x10 26W	10x10 27W	10x10 28W	10x10 29W	10x10 30W	10x10 31W	10x10 32W	10x10 33W	10x10 34W	10x10 35W	
																			C
C	10x10 36W	10x10 37W	10x10 38W	10x10 39W	10x10 40W	10x10 41W	10x10 42W	10x10 43W	10x10 44W	10x10 45W	10x10 46W	10x10 47W	10x10 48W	10x10 49W	10x10 50W	10x10 51W	10x10 52W	10x10 53W	
																			C

WEST HALL

OFFICE REST ROOMS

C	10x10 54W	10x10 55W	10x10 56W	10x10 57W	10x10 58W	10x10 59W	10x10 60W		10x10 61W	10x10 62W	10x10 63W	10x10 64W	10x10 65W	10x10 66W	10x10 67W	10x10 68W	10x10 69W		9x10 70W	10x10
							C		C								C		C	

Emergency Exit

Emergency Exit

Emergency Exit

10x10 72W  
16x10 73W  
10x10 71W

LARGE OVERHEAD DOOR

WEST HALL

